



FIG 1: American

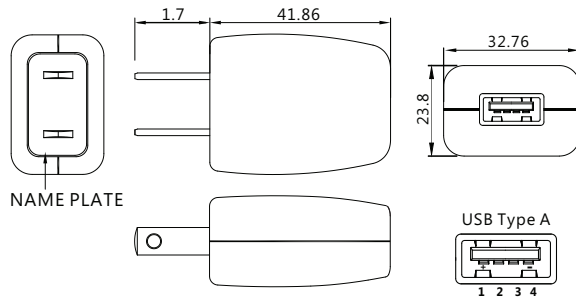
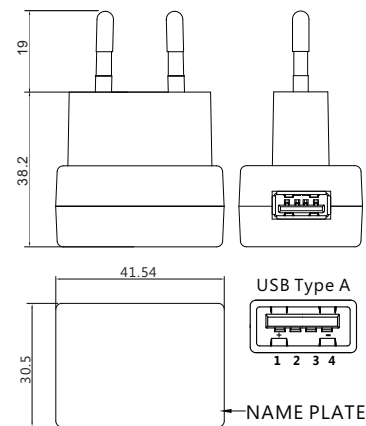
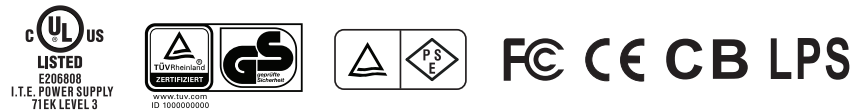

FIG 2: European



■ Safety agency approvals:



■ Specifications:

Model No.	<b>APSU06-USB</b>
AC input range	100~240VAC; 47~63Hz; 0.2A
Leakage current	0.25mA Max.@ 240VAC/50Hz
Operating temperature	-20°C to ~+70°C (safety approval 0°C to 40°C, >40°C please contact the sales request derating curve.)
Withstand voltage	4242VDC from input to output
EMC	(A) CE EN 55032, EN 55024 (B) FCC 47 CFR Part 15 Subpart B
Safety	(A) UL/cUL (B) TUV/GS (C) TUV/PSE (D) CB
Warranty	1 year

■ X= U: (American type FIG 1) or E: (European type FIG 2)

Model name	Output Voltage(VDC)	Output Current(A)	Max.Output power(W)	Ripple.(mV) max.	Line Regulation(%)	Load Regulation(%)	Avg.Eff.(%) DoE(VI)_CoC(5)	No load Power Consumption(W)	Measured at the output of
APSU06X-1-USB	5	1.2	6	50	±1	±5	>75	<0.1	5

Note:  
1.Weight: Approx 70~100gs  
2.Avg. Eff.(%): Averages the efficiency at 25, 50, 75, and 100 % of max. rated output current.